



MPR-S500H

MPR-S500RH

## MPR Pharmaceutical Refrigerators with Natural Refrigerants

+2°C to +14°C



554 L (H) / 550 L (RH)

### Uniform storage temperature for the most demanding applications

MPR Pharmaceutical Refrigerators offer a complete solution for the most demanding requirements for storage of pharmaceuticals, medicines, vaccines, and other temperature-sensitive applications.

### Natural Refrigerants and Inverter Technology

Hydrocarbon [HC] refrigerants have minimal effect on the environment and are compliant with environmental legislation for climate control. Combined with inverter technology, these refrigerants also provide more efficient cooling without compromising cooling performance, ambient tolerance and recovery time following door openings.

### OLED Control Panel

The microprocessor controller and OLED display have good visibility and intuitive operation. Control buttons allow convenient but secure user control. Refrigerator temperature can be displayed in 0.1°C increments. Minimum/maximum temperatures are automatically displayed every 12/24 hours. All alarm conditions are displayed and recorded.

### User-friendly Design

The ergonomic design of the MPR Pharmaceutical Refrigerators provides a clear view of stored items through the large glass door. The slim, hassle-free sliding glass door allows for easy retrieval of products, without the concern for swinging door clearance. Users can prevent unauthorized access by utilizing the keylock on the door.



### Energy-efficient performance

Natural refrigerants, compressors and integrated electronics combine to achieve facility sustainability objectives by minimising any environmental impact without compromising cooling performance, ambient tolerance and recovery time following door openings.



### Safe & Secure storage

Adjustable audible and visual alarms are standard, along with integrated system diagnostics and predictive performance supervision. The password-protected control panel provides security and minimises risk of accidental changes. If desired, alarm and operating history can be uploaded through the USB port.



### Enhanced sliding glass door

The sliding glass door is meticulously designed to increase energy efficiency and safeguards stored items against heat transfer through the window. The thermal glass door is constructed from a double glass pane where argon gas is used to fill the 12 mm gap. Together with the air vents near the sliding glass door rail, it prevents the formation of moisture.

# Pharmaceutical Refrigerators with Natural Refrigerants

## Shelves & Racks

The lineup consists of MPR-S500H equipped with regular shelves on both sides, and MPR-S500RH with racks on the right side (shelves on the left side).



## LED Interior Light

The LED interior light automatically turns on/off in conjunction with the door opening/closing. It can also be controlled from the control panel.



## Dimensions

Unit : mm

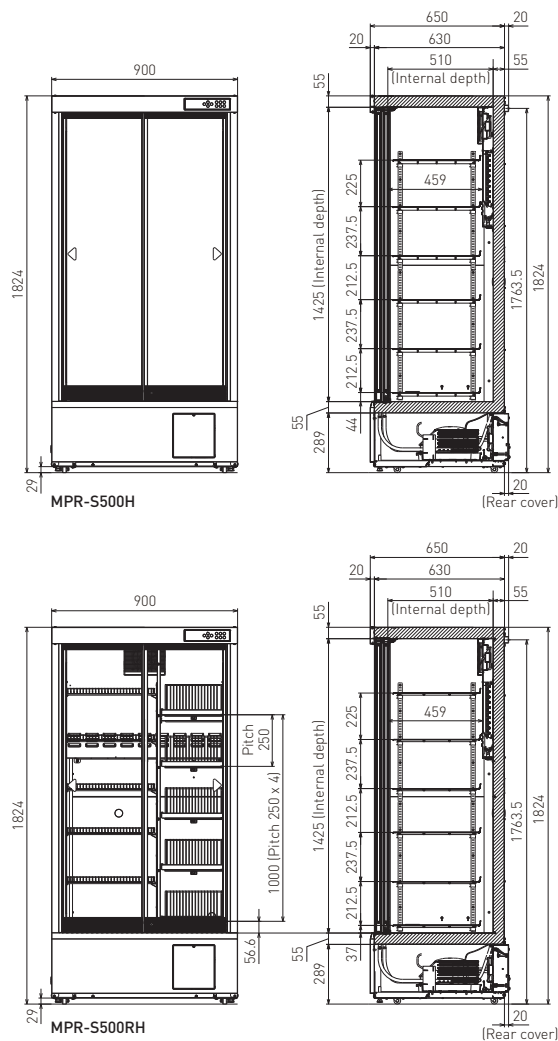

Model Number	MPR-S500H-PE/MPR-S500H-PK MPR-S500H-PA	MPR-S500RH-PE/MPR-S500RH-PK MPR-S500RH-PA
External dimensions (W x D x H) <sup>1)</sup>	mm	900 x 650 x 1824
Internal dimensions (W x D x H)	mm	800 x 510 x 1425
Volume	litres	554
Net weight	kg	140 [PE] / 140 [PK] / 139 [PA]
		146 [PE] / 146 [PK] / 145 [PA]
<b>Performance</b>		
Temperature control range <sup>2)</sup>	°C	+2 to +14
<b>Control</b>		
Controller	Microcomputer control system	
Display	Digital display (lin 1°C, 0.1°C increments)	
Temperature sensor	Thermistor sensor	
<b>Refrigeration</b>		
Cooling method	Forced cool air circulation	
Defrost method	Cyclical defrost + forced defrost	
Refrigerant	R-600a	
Insulation	Rigid polyurethane foamed-in place	
<b>Construction</b>		
Exterior material	Painted Steel	
Interior material	Painted Steel	
Outer doors	qty	x2 (Highly insulated double glass door with tempered glass)
Outer door lock	Y	
Shelves	qty	x6 (Hard steel wire on polyethylene coating)
Dimensions	mm	W781 x D420
Max. load - per shelf	kg	50
Access port	qty	2
Access port position	Back	
Access port diameter	Ø mm	30
Casters	qty	x4
Interior light	LED x12	
<b>Accessories</b>		
Key	qty	x2
<b>Alarms</b> (V = Visual Alarm, B = Buzzer Alarm, M = Message, R = Remote Alarm)		
Power failure <sup>3)</sup>	R <sup>3)</sup>	
High temperature	V-B-M-R	
Low temperature	V-B-M-R	
Door open	V-B-M	
<b>Electrical and Noise Level</b>		
Power supply	V / Hz	PE: 220, 230, 240/50 PK: 220/60 PA: 115/60
Noise level <sup>4)</sup>	dB (A)	42
<b>Options</b>		
Temperature chart recorders	PE & PK: MTR-0621LH-PE	PA: MTR-0621LH-PA
- Chart paper	RP-06-PW	
- Recorder housing	MPR-S30W-PW	
Circular type chart recorders	PE & PK: MTR-G04C-PE, PA: MTR-G04A-PA	
- Chart paper	RP-G04-PW	
- Ink pen	PG-R-PW	
- Recorder housing	MPR-S7-PW	
Battery kit for power failure alarm	MPR-48B2-PW	
Name card holder	MPR-50CH-PW	MPR-50RCH-PW
<b>Optional Communication Systems</b>		
Digital interface (RS232C/RS485) <sup>5)</sup>	MTR-480-PW	
Ethernet interface (LAN) <sup>5)</sup>	MTR-L03-PW	
<b>Quality Management System</b>		
Certification	ISO9001	

<sup>1)</sup> Exterior dimensions of main cabinet only, excluding external projections - See dimensions drawings on website for full details.

<sup>2)</sup> Air temperature measured at refrigeration compartment center, ambient temperature +35°C, no load.

<sup>3)</sup> Remote alarm includes optional power failure alarm MPR-48B2-PW (V-B-M-R alarm).

<sup>4)</sup> Nominal value - Background noise 20dB (A)

<sup>5)</sup> Only for MTR-5000 (data acquisition system) users.

• Appearance and specifications are subject to change without notice.

**Caution:** PHC Corporation guarantees this product under certain warranty conditions. However, please note that PHC Corporation shall not be responsible for any loss or damage to the contents stored in the product.



Preservation Equipment, Experimental Environment Equipment, Dispensary Equipment, Culturing Equipment and Drying & Sterilising Equipment for General Laboratory use

The management of the design, development, production and servicing of the above.

PHC Corporation, Biomedical Division

1-1-1 Sakada, Oizumi-machi, Ora-gun, Gunma 370-0596, Japan



PHC Corporation Biomedical Division is certified for:

Environmental management system: ISO14001

DISTRIBUTED BY:

**PHCbi**  
PHC Corporation

<https://www.phchd.com/global/biomedical/>

Printed in Japan 2112-2021-06-AA